

Korrvu[®] Packaging Retention Box Packing Instructions

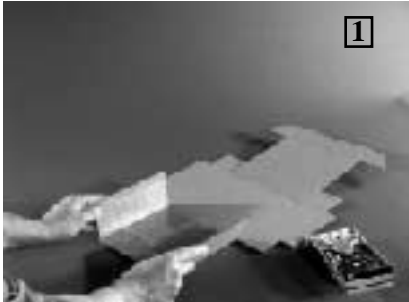

- Start with film side up
- Fold flaps up to release film



- Slide product under film



- Fold flaps down to stretch film and create tension
- Flaps will fold all the way behind base portion



- Fold front panel up
- Panel will "click in place"

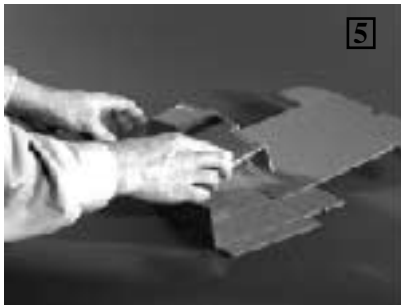

- Roll base portion up and around
- Base will be upside down and resting on front panel



- Fold small side flaps in
- Lift sides up



- Fold small top flaps over
- Fold small side flaps in



- Fold lid up and over



- Tuck tabs in to close